

*Victoria Plaza Revisited:  
Lessons for the Evaluation of  
Housing for the Elderly*

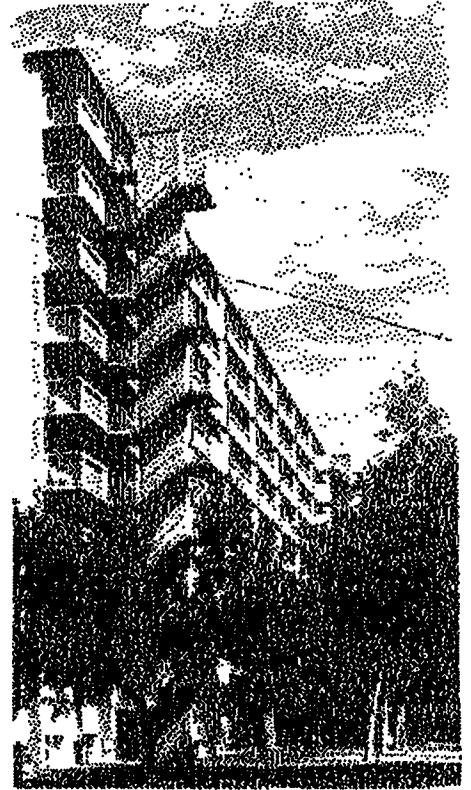

*Frances M. Carp*  
*Arza Churchman, Editor*

*Institute on Aging and Environment  
University of Wisconsin-Milwaukee*

**VICTORIA PLAZA REVISITED:  
Lessons for the Evaluation of  
Housing for the Elderly**

Frances M. Carp

*Editor*

Arza Churchman

*Contributors*

Min Kantrowitz

Gerald D. Weisman

Habib Chaudhury

**This monograph, and the special session at the 24th Environmental Design Research Association Annual Conference upon which this monograph is based, were funded in part by the Institute on Aging and Environment and the Helen Bader Charitable Trusts.**

© Institute on Aging and Environment, 1994

**VICTORIA PLAZA REVISITED:  
LESSONS FOR THE EVALUATION OF HOUSING FOR THE ELDERLY**

*Editor* Arza Churchman

*Contributors* Frances M. Carp, Min Kantrowitz, Gerald D. Weisman, and Habib Chaudhury

*Abstract*

This monograph is based upon a workshop sponsored by the Institute on Aging and Environment at the 1994 EDRA Conference. San Antonio is the home of Victoria Plaza, the first public housing facility specifically designed for and limited to older persons, where Frances Carp conducted a nine year longitudinal study of the effects of the housing on its residents. The convening of the 25th Annual Meeting of the Environmental Design Research Association in San Antonio in March of 1994, offered the opportunity to use the occasion to mark the significance of the Victoria Plaza study and to reflect on the substantive and methodological lessons that can be learned from it. The monograph includes Frances Carp's reflections on her pioneering experiences with Post Occupancy Evaluation and the lessons applicable today. Min Kantrowitz and Gerald Weisman present their comments and conclusions.

Pp. vi+96; plans and illustrations

Cover photographs courtesy of the San Antonio Housing Authority

*Cover design and layout* Habib Chaudhury

**PUBLICATIONS IN ARCHITECTURE AND URBAN PLANNING**

Center for Architecture and Urban Planning Research  
University of Wisconsin-Milwaukee  
P.O. Box 413  
Milwaukee, Wisconsin 53201-0413

Report R94-7  
ISBN 0-938744-88-7

Additional copies of this report are available for \$15.00 prepaid by writing to the above address.

## Related Books and Monographs

by members of the Institute on Aging and Environment

*Books which can be ordered from  
the Center for Architecture and  
Urban Planning Research*

**Environments for people with dementia: Illustrative designs** (1990). Cohen, U., Weisman, G., Day, K., Robison, W., Dicker, J., & Meyer, G. Milwaukee, WI: Center for Architecture and Urban Planning Research.

**Programming and design for dementia: Development of a 50 person residential environment.** (1990). Weisman, G., Cohen, U., & Day, K. Center for Architecture and Urban Planning Research: Monograph Series: Milwaukee, WI: Center for Architecture and Urban Planning Research.

**Environments for people with dementia: Annotated bibliography, Vol. II.** (1994). Barisas, M., Calkins, M., Chaudhury, H., Johansen, D., & Proffitt, M. Milwaukee, WI: Center for Architecture and Urban Planning Research.

*Books which can be ordered from  
the AIA/ACSA Council on  
Architectural Research*

**Environments for people with dementia: Annotated bibliography, Vol. I.** (1987). Rand, J., Steiner, V., Toyne, R., Cohen, U., & Weisman, G. Washington, D.C.: Health Facilities Research Program, AIA/ACSA Council on Architectural Research.

**Environments for people with dementia: Case Studies.** (1988). Cohen, U., Weisman, G., Ray, K., Rand, J., & Toyne, R. Washington, D.C.: Health Facilities Research Program, AIA/ACSA Council on Architectural Research.

**Environments for people with dementia: Design Guide.** (1988). Cohen, U., Weisman, G., Ray, K., Rand, J., & Toyne, R. Washington, D.C.: Health Facilities Research Program, AIA/ACSA Council on Architectural Research.

**Environments for people with dementia: Regulatory Analysis.** (1988). Cohen, U., Weisman, G., Day, K., & Ray, K. Washington, D. C.: Health Facilities Research Program, AIA/ACSA Council on Architectural Research.

*Books which can be ordered from  
other publishers*

**Design for Dementia: Planning environments for the elderly and confused** (1988). Calkins, M. P. Milwaukee, WI: Ideas Inc.

**Holding on to home: Designing environments for people with dementia.** (1991). Cohen, U. & Weisman, G. Baltimore, MD: Johns Hopkins University Press.

**Contemporary environments for people with dementia.** (1993). Cohen, U., & Day, K. Baltimore, MD: Johns Hopkins University Press.

## Table of Contents

<b>1</b>	<b>Introduction</b> <i>Arza Churchman</i> .....	3
<b>2</b>	<b>Housing Older Persons: The Victoria Plaza Experience</b> <i>Frances M. Carp</i> .....	11
<b>3</b>	<b>Time, Age, Research: Comments on Frances M. Carp's "The Victoria Plaza Experience"</b> <i>Min Kantrowitz</i> .....	51
<b>4</b>	<b>Learning from Victoria Plaza</b> <i>Gerald D. Weisman</i> .....	57
<b>5</b>	<b>Victoria Plaza: Description of the Facility</b> <i>Habib Chaudhury</i> .....	63

### Appendix

Victoria Plaza Apartments, brochure of  
San Antonio Housing Authority, 1961.