

Density Measures and their Relation to Urban Form

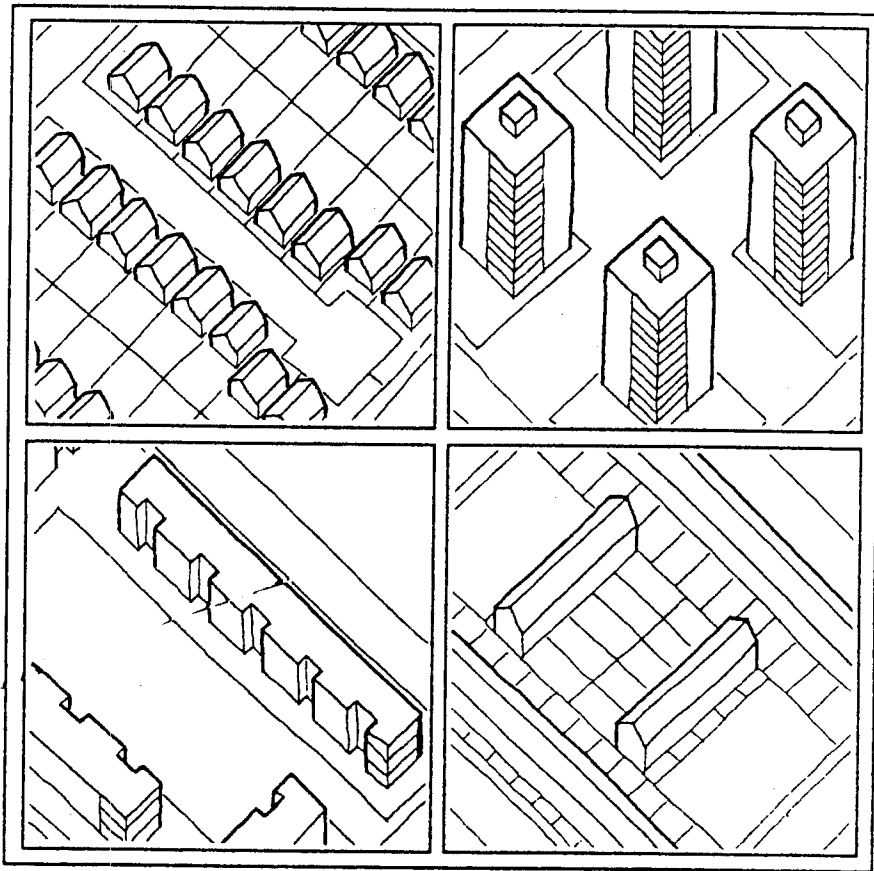

Ernest R. Alexander and K. David Reed
with Peter Murphy

The School of The
Architecture University of
& Urban Wisconsin
Planning Milwaukee

Density Measures and their Relation to Urban Form

Ernest R. Alexander and K. David Reed
with Peter Murphy

Center for Architecture and Urban Planning Research
University of Wisconsin-Milwaukee

June 1988

Density Measures and their Relation to Urban Form

Ernest R. Alexander and K. David Reed
with Peter Murphy

Abstract:

The relationship between density and urban form is explored, using four dwelling types: single family detached housing, row housing, low-rise garden apartments, and high-rise multi-family housing. Preceding research is reviewed, presenting various concepts of density, and relating conflicting prior density measures to a set of clear definitions. 99 typical site layouts of the four dwelling types were developed by systematically changing variables including unit size, lot size, and block configuration. The relation between these variables and the resulting densities was analysed using regression and multiple correlation analysis. Examples of actual housing developments accompany the review, relating their physical and environmental characteristics to the densities generated in the abstract schemes. Conclusions include qualified support for the relationship between dwelling type and density range, specifically for single family and high-rise housing, but row housing and low-rise multifamily housing share a broad range of intermediate densities.

Pp.183, drawings, diagrams, tables, bibliography.

Publications in Architecture and Urban Planning

Center for Architecture and Urban Planning Research
University of Wisconsin-Milwaukee
P.O.Box 413, Milwaukee, Wisconsin 53201.

R88-3

ISBN No: 0-938744-60-7

Additional copies of this report are available for \$20.00 prepaid by writing to the above address

Contents:

Chapter 1: Background and Concepts	1
Chapter 2: Review: Density Measures and Research	9
Chapter 3: Deductive Analysis	27
Chapter 4: Inductive Analysis	41
Appendix A: Case Studies	57
Appendix B: Annotated Bibliography	157

List of Figures:

Figure 1-1 Perceived Density - Contributing Factors	4
Figure 2-1: Density and Built Form Analysis	19
Figure 2-2: Neighborhood Density Analysis	20
Figure 2-3: Housing Type and Density Relationships	21
Figure 2-4: Density Analysis of Neighborhood	22
Figure 2-5: Deductive Density Schema	24
Figure 3-1 Physical Variables	28
Figure 3-2: Distribution of NDD by Dwelling Types	31
Figure 3-3: Density-Lot Area Relationships a. All Dwelling Types b. Single Family Detached Housing c. Row Housing	38
Figure 4-1: Physical Variables	41
Table 4-2: Single Family Detached Housing Types	43
Figure 4-3: Single Family Detached Housing: Density Range	43
Figure 4-4: Row Housing Types	44

Figure 4-5: Row Housing: The Density Range	44
Figure 4-6: Low-rise "Garden" Apartment Types	45
Figure 4-7: Low-rise "Garden" Apartments: Density Range	45
Figure 4-8: High-rise Apartment Types	46
Figure 4-9: High-rise Apartments: The Density Range	46
Figure 4-10: Lot Size	47
Figure 4-11: Block Variables	48
Figure 4-12: Variation in Setback from the Street	49
Figure 4-13: Privacy within the Building Lot	50
Figure 4-14: Privacy from the Street	51
Figure 4-15: Privacy from Overlooking	52
Figure 4-16: Street Proportions	53
Figure 4-17: Orientation Considerations	54
Figure 4-18: Housing Oriented to All Points of the Compass	55
Figure 4-19: Relation of Parking to the Dwelling Unit	56

List of Tables:

Table 2-1: Comparative Density Measures	11
Table 3-1: Density Layout Schemes	32
Table 3-2: Analysis of Density Related Variables	35
Table 4-1: Critical Design Factors	42

Acknowledgements:

This project was supported by a grant from the National Endowment for the Arts in Washington, D.C., a Federal agency.

We would also like to acknowledge the graphic contribution to Appendix A of Paul Trebian.